

## SUNLIGHT SENSITIVE photo diode

### OSD9-SC

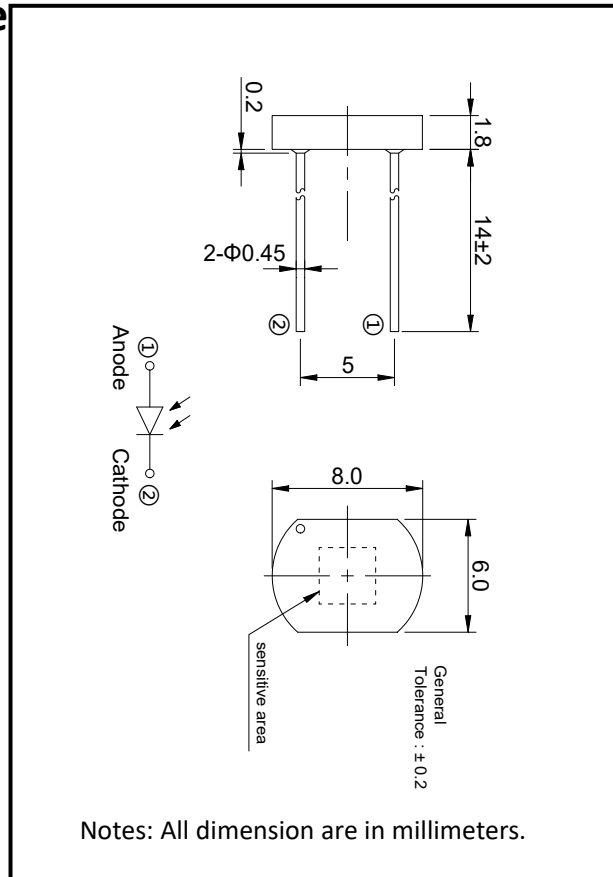
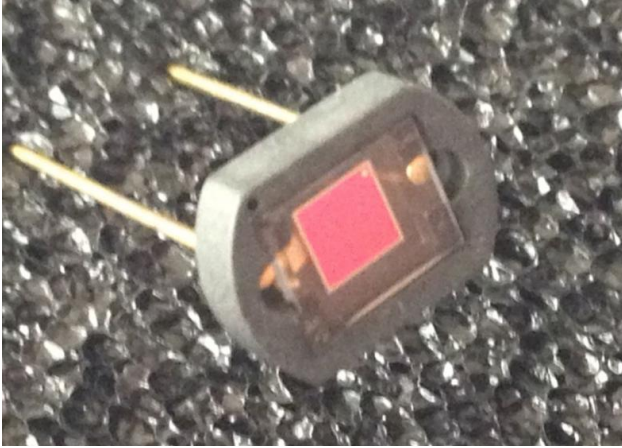

### Description

The OSD9-SC is sunlight sensitive high-output, high-speed silicon photo diode which is mounted in 2PIN ceramic package, permits wide angular response.

### Applications

\*sunlight sensor \* light control temperature

### Absolute Maximum Ratings (Ta=23°C)



Parameter	Symbol	Condition	Min.	Typ.	Max.	Unit
Chip size	size	-		2.54*2.54		mm <sup>2</sup>
Active area	A	-		2.25*2.25		mm <sup>2</sup>
Dark current	I <sub>D</sub>	V <sub>R</sub> =10mV		10		pA
		V <sub>R</sub> =10V		50		
Rise time	t <sub>R</sub>	V <sub>R</sub> =0V; λ =535nm;R <sub>L</sub> =50Ω		300		ns
Tempcoeffi-cient of I <sub>D</sub>	T <sub>CI D</sub>			0.18		times/°C
Reverse breakdown voltage	V <sub>(BR)R</sub>	I <sub>R</sub> =100uA E <sub>v</sub> =0mw/cm <sup>2</sup>	5			V
Junction Capacitance	C <sub>J</sub>	V <sub>R</sub> =0V f=1MHz E <sub>e</sub> =0mW/cm <sup>2</sup>		190		pF
		V <sub>R</sub> =5V f=1MHz E <sub>e</sub> =0mW/cm <sup>2</sup>		120		
Photo sensitivity	S <sub>R</sub>	450nm		0.25		A/W
Spectral Application Range	λ range		300		900	nm
Spectral Response-Peak	λ <sub>p</sub>			450		nm
Shunt resistance	R <sub>sh</sub>	V <sub>R</sub> =10mV		0.1		GΩ
Angular Resp 50% Resp Pt	θ <sup>1/2</sup>			±20		Degrees



# OSD9-SC

### SPECTRAL RESPONSE (Ta=23°C)

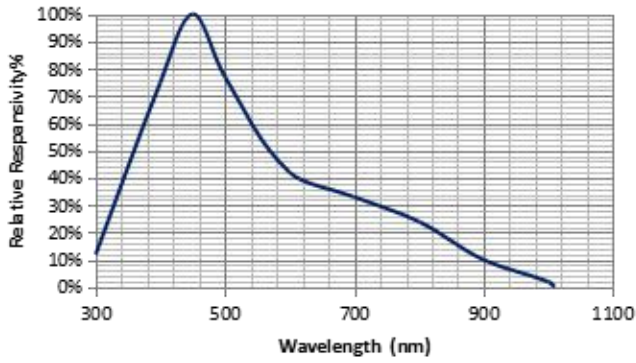

### DARK CURRENT VS. REVERSE VOLTAGE (Ta=23°C)

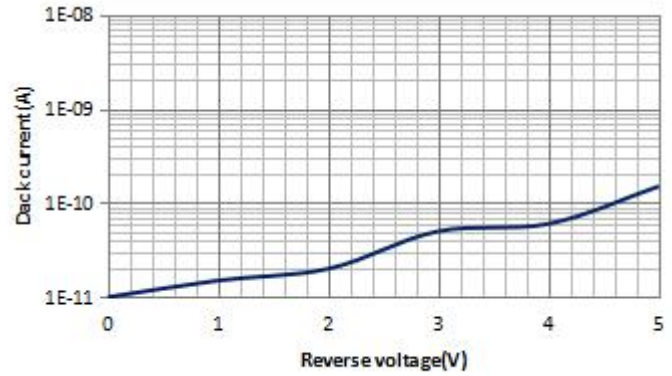

### CAPACITANCE VS. REVERSE VOLTAGE (Ta=23°C)

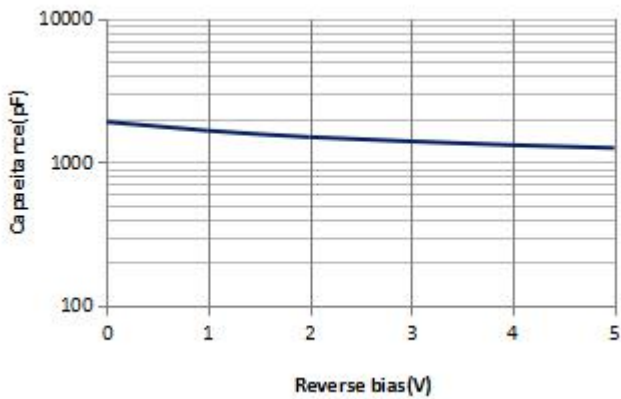

Information in this technical datasheet is believed to be correct and reliable. However, no responsibility is assumed for possible inaccuracies or omission. Specifications are subject change without notice.

OTRON ELECTRONIC TECHNOLOGY CO.LTD

TEL:+86-21-54971821

FAX:+86-21-54971823

EMAIL:frank.shuai@e-otron.com

<http://www.e-otron.com>